



inserts:	page:
CK 3 poles + ⊕	48
CK 4 poles + ⊕	48
CKS 3 poles + ⊕	49
CKS 4 poles + ⊕	49
CD 7 poles + ⊕	53
CD 8 poles	54
CQ 12 poles + ⊕	165
CQ 5 poles + ⊕	166

insert dimensions:
21 x 21 mm

bulkhead mounting housings



angled bulkhead mounting housings



description	part No.	part No. (entry - Pg 11)	part No. (entry - M 20)
with lever	CK 03 I (white)		
with lever	CK 03 IN (black)		
without cable entry, with lever		CK 03 IA (white)	
without cable entry, with lever		CK 03 IAN (black)	
with cable entry and lever		CK 03 IAPS (white)	MK IAP20 (white)
with cable entry and lever		CK 03 IAPNS (black)	MK IAPN20 (black)
gasket and screw kit for IP66/IP67 ¹⁾ for CK, CQ 05, CKS inserts	CKR 65	CKR 65	
gasket and screw kit for IP66/IP67 ¹⁾ for CD 07/08 inserts	CKR 65 D	CKR 65 D	

1) To obtain the protection rating IP66/IP67 a kit is provided that includes a gasket to fit under the insert fixing screws supplied with the kit (see illustrative example).
CQ 12 inserts are already supplied with a gasket and screw which ensure IP66/IP67 protection rating.

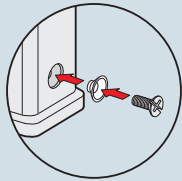

panel cut-out for enclosures, in mm

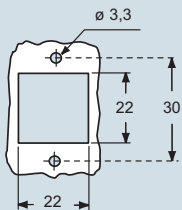

dimensions in mm

CK I(N)

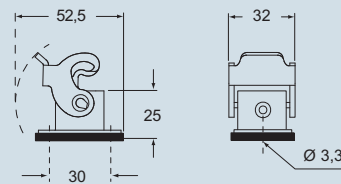

dimensions in mm

CK IA(N)

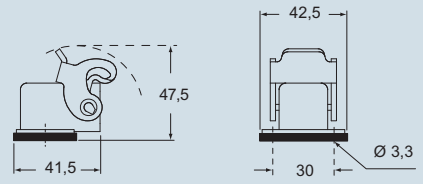

CK IAP(N)S and MK IAP(N)

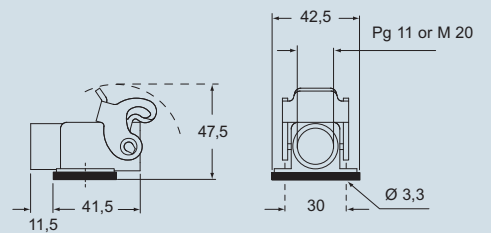

CRUS Type 12
Type 4/4X only
with CKR 65 (D)



IP66/IP67 with CKR 65 (D) ¹⁾

dimensions shown are not binding
and may be changed without notice



inserts:	page:
CK 3 poles + ⊕	48
CK 4 poles + ⊕	48
CKS 3 poles + ⊕	49
CKS 4 poles + ⊕	49
CD 7 poles + ⊕	53
CD 8 poles	54
CQ 12 poles + ⊕	165
CQ 5 poles + ⊕	166

insert dimensions:
21 x 21 mm



description	part No. (entry - Pg 11)	part No. (entry - M 20)	part No. (with eyelet)	part No. (with loop)
with pegs, top entry	CK 03 VS (white)	MK V20 (white)		
with pegs, top entry	CK 03 VNS (black)	MK VN20 (black)		
with pegs, side entry	CK 03 VAS (white)	MK VA20 (white)		
with pegs, side entry	CK 03 VANS (black)	MK VAN20 (black)		
with lever, top entry	CK 03 VGS (white)	MK VG20 (white)		
with lever, top entry	CK 03 VGNS (black)	MK VGN20 (black)		
with pegs and gasket, for female inserts			CK 03 C (white)	CK 03 CS (white)
with pegs and gasket, for female inserts			CK 03 CN (black)	
with pegs, for male inserts			CK 03 CA (white)	CK 03 CAS (white)
with pegs, for male inserts			CK 03 CAN (black)	
with lever and gasket, for female inserts				CK 03 CX (white)
with lever and gasket, for female inserts				CK 03 CXN (black)
with lever, for male inserts				CK 03 CXA (white)
with lever, for male inserts				CK 03 CXAN (black)
gasket and screw kit for IP66/IP67 ¹⁾ for CK, CQ 05, CKS inserts	CKR 65			
gasket and screw kit for IP66/IP67 ¹⁾ for CD 07/08 inserts	CKR 65 D			

1) To obtain the protection rating IP66/IP67 a kit is provided that includes a gasket to fit under the insert fixing screws supplied with the kit (see illustrative example).
CQ 12 inserts are already supplied with a gasket and screw which ensure IP66/IP67 protection rating.

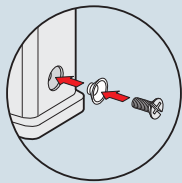

dimensions in mm

CK V(N)S and MK V(N)

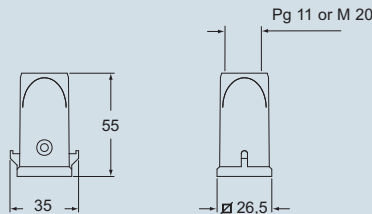

CK VA(N)S and MK VA(N)

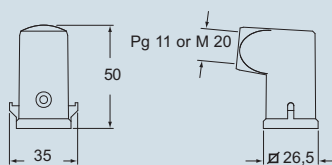

CK VG(N)S and MK VG(N)

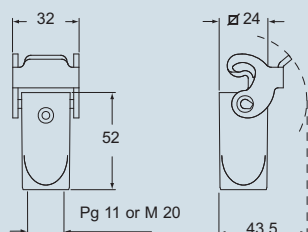

dimensions in mm

CK C(S)(N)

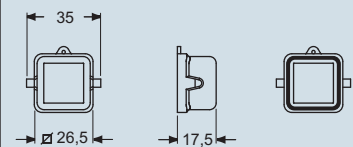

CK CA(S)(N)

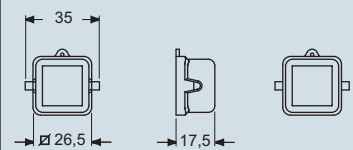

CK CX(N)

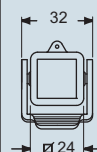

CK CXA(N)

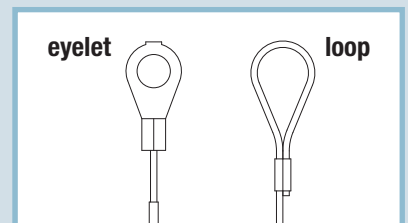
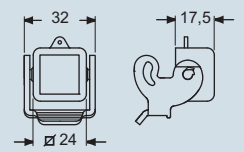

CRUS Type 12
Type 4/4X only
with CKR 65 (D)

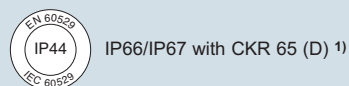

dimensions shown are not binding
and may be changed without notice

C-TYPE - size 21.21